



# RP-3000 Remote Panel for easYgen-3000 Series Genset Controls

## DESCRIPTION

The **RP-3000** is a remote control and annunciation panel for use with the back-panel mounted **easYgen-3100/3400** or door-mounted **easYgen-3200/3500** genset controls.

It offers switchgear builders an off-the-shelf HMI option for any application where remote control is desired, such as hospitals, marine switchboards, drill platforms, data centers, landfill and wastewater gas-to-power applications or other outdoor switchgear installations.

The **RP-3000** is an ideal solution for door-mounted applications, providing control from the front panel with greatly reduced wiring to the access door, while keeping high-voltage connections located safely on the back panel.

The **RP-3000** allows remote control, remote visualization (including a synch-scope), and password-protected remote configuration of the **easYgen-3000 Series** generator controls, with access to its complete menu structure and all parameter settings.

It has the same look and feel as the **easYgen-3200** or **easYgen-3500** genset control.

Each **RP-3000** remote panel communicates with a single **easYgen-3000 Series** genset control via CAN communication. A single relay output is provided to signal "Ready for Operation".

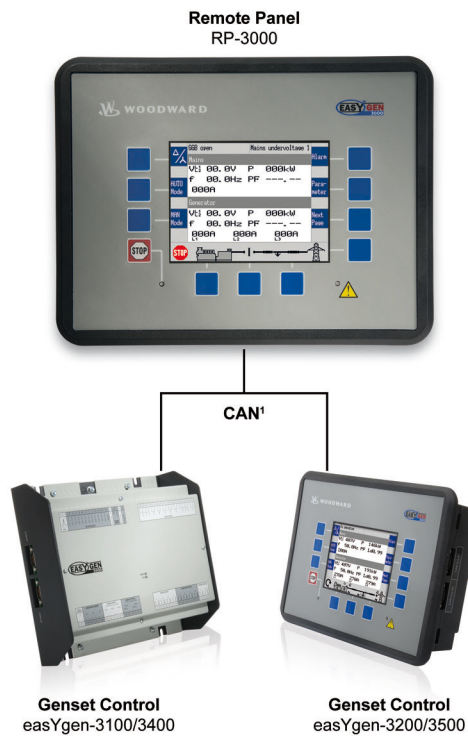

<sup>1</sup> Only one easYgen can be connected at once.

- Remote annunciation and remote control of the easYgen-3000 Series generator controls
- Password-protected remote configuration for all parameter settings
- Same look and feel as the easYgen-3200/3500 display
- Color display
- CAN communication to genset control
- Multi-lingual Capability
- CE Marked
- UL / cUL Listing
- LR & ABS Marine
- DNV<sup>1</sup>

## Features

- Each **RP-3000** connects directly to one **easYgen-3100/3400** or **easYgen-3200/3500** via CAN Bus communication port
- Output relay signal indicates "Ready for Operation"
- Multi-lingual display capability

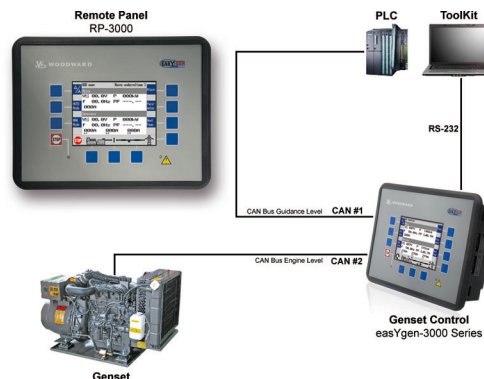

<sup>1</sup> For details see last page

# SPECIFICATIONS

**Power supply** ..... 12/24 Vdc (8 to 40 Vdc)  
 Intrinsic consumption ..... max. 12 W  
 Ambient temperature (operation) ..... -20 to 70 °C / -4 to 158 °F  
 Ambient temperature (storage) ..... -30 to 80 °C / -22 to 176 °F  
 Ambient humidity ..... 95 %, non-condensing  
**Relay output** ..... potential free  
 Contact material ..... AgCdO  
 Load (GP) ..... 2.00 Aac@250 Vac  
 ..... 2.00 Adc@24 Vdc / 0.36 Adc@125 Vdc / 0.18 Adc@250 Vdc  
 Pilot duty (PD) .....  
 ..... 1.00 Adc@24 Vdc / 0.22 Adc@125 Vdc / 0.10 Adc@250 Vdc



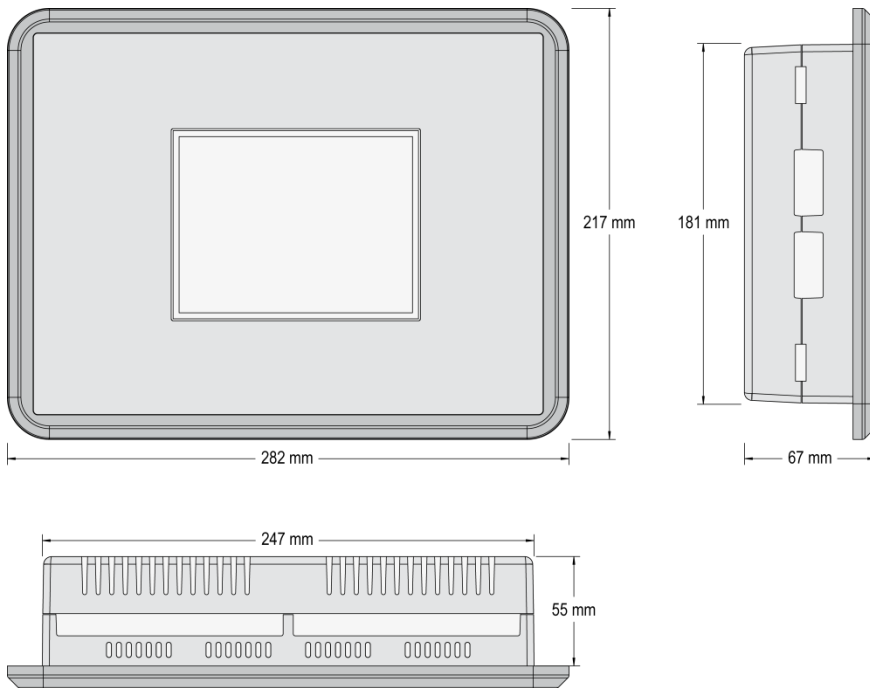

**Housing** Front panel flush mounting ..... Plastic housing  
 Dimensions WxHxD ..... 282 × 217 × 67 mm  
 Front cutout WxH ..... 249 [+1.1] × 183 [+1.0] mm  
 Connection ..... screw/plug terminals 2.5 mm<sup>2</sup>  
 Front ..... insulating surface  
**Sealing** Front ..... IP66 (with screw fastening)  
 Front ..... IP54 (with clamp fastening)  
 Back ..... IP10  
 Weight ..... approx. 1,300 g  
**Disturbance test (CE)** ..... tested according to applicable EN guidelines  
**Listings** ..... UL / cUL  
**Marine** ..... LR (Type Approval), ABS (Design Assessment), DNV

# DIMENSIONS

## Plastic housing for front panel mounting



# TERMINAL DIAGRAM

			Serial RS-232 isolated (Interface #1)	
			Relay [R 01] isolated Fixed to „Ready for operation“	[R 01] 
				41
				42
				43
				44
				45
				46
				47
				48
				49
				50
				51
				52
				53
				54
				55
				56
				57
				58
				59
				60
			Protective earth PE	 61
				62
			Power supply	63
			12/24 Vdc 8 to 40 Vdc 0 Vdc	64
				65
				66
				67
				68
				69
				70
				71
				72
				73
				74
				75
				76
				77
				78
				79
				80
		RP-3000 Remote Panel	CAN bus Guidance level isolated (Interface #2)	

Subject to technical modifications.

**International**

Woodward  
 PO Box 1519  
 Fort Collins CO, USA  
 80522-1519  
 1000 East Drake Road  
 Fort Collins CO 80525  
 Ph: +1 (970) 482-5811  
 Fax: +1 (970) 498-3058

**Europe**

Woodward GmbH  
 Handwerkstrasse 29  
 70565 Stuttgart, Germany  
 Ph: +49 (0) 711 789 54-0  
 Fax: +49 (0) 711 789 54-100  
 email: stgt-info@woodward.com

**Distributors & Service**

Woodward has an international network of distributors and service facilities. For your nearest representative, call the Fort Collins plant or see the Worldwide Directory on our website.

[www.woodward.com/power](http://www.woodward.com/power)

For more information contact:

Subject to technical modifications.

This document is distributed for informational purposes only. It is not to be construed as creating or becoming part of any Woodward Governor Company contractual or warranty obligation unless expressly stated in a written sales contract.

We appreciate your comments about the content of our publications. Please send comments including the document number below to [stgt-doc@woodward.com](mailto:stgt-doc@woodward.com)

© **Woodward**

**All Rights Reserved**

37446E - 2011/09/Stuttgart

## FEATURES OVERVIEW

		Model	RP-3000
<b>HMI</b>			
Soft keys (advanced LCD display)	<i>DynamicsLCD™</i>		Yes
Color display			✓
<b>I/Os</b>			
CAN bus communication interfaces	<i>FlexCAN™</i>		1
RS-232			1
Relay output ( Ready for operation )			1
<b>Listings/Approvals</b>			
UL / cUL Listing			✓
LR Marine Type Approval			✓
ABS Marine Design Assessment			✓
DNV			✓ (P/N 8446-1046 only)
CE Marked			✓
<b>Part Numbers</b>			
Front panel mounting with display (easYgen-3100/3200/3400/3500)	P/N 8446-		1048
Front panel mounting with display (easYgen-3400/3500 Marine)	P/N 8446-		1046
Spare connector kit	P/N 8923-		1314

## RP-3000 OVERVIEW

The following easYgen-3000 genset controls are supported by the RP-3000 remote panel.

RP-3000	P/N 8446-1048	P/N 8446-1046
easYgen-3100/3200 Package P1 <sup>1</sup> / Package P2 <sup>2</sup>	✓	-
easYgen-3400/3500 Package P1	✓	-
easYgen-3400/3500 Marine Package P1	-	✓

<sup>1</sup> easYgen-3100/3200 Package P1 software version 1.15xx or higher.

<sup>2</sup> easYgen-3100/3200 Package P2 software version 1.13xx or higher.